



429 Seabreeze Boulevard  
Fort Lauderdale, FL 33316  
(954) PRO-DIVE (776-3483) • (800) PRO-DIVE  
[www.prodiveusa.com](http://www.prodiveusa.com)

## ORIENTATION PACKET

Class(es) Enrolled \_\_\_\_\_

Class Start Date \_\_\_\_\_

Your Instructor(s) \_\_\_\_\_

***Congratulations on training with Pro Dive!***

***To make your experience thorough, safe and fun, it is very important to read this document in its entirety. Please complete the last three pages of this packet.***

"

***Thank you!***

"

"

"

## ***Welcome to Pro Dive***

Thank you for choosing Pro Dive as your dive training school. Whether you are a non-diver seeking your entry-level training, or you are on your way to becoming a PADI Instructor, we ask that you follow a few guidelines to make your stay enjoyable and your learning experience more productive.

### ***1. Where will my scuba training take place?***

Your training will take place on the Pro Dive campus. We are located in Fort Lauderdale, just one block from the beach. Our campus consists of our main building, our boat the *Pro Diver II* (docked on-site), the Ft. Lauderdale Aquatic Complex (Swimming Hall of Fame), Ft. Lauderdale Beach, and Tigertail Lake. Our main building houses our dive center, three classrooms, administrative offices, gear locker, and Coconuts Waterfront Restaurant. See our Campus Map on page 7.

### ***2. What should I get before class begins?***

**Books & Materials** – At Pro Dive, your classes may include your required books and materials or not, depending on the course. You will either receive your books shipped in advance, or you will pick them up on-location – or a combination thereof. If picking up your books on-location, please allow enough time to properly read and complete required assignments prior to your first class. A list of these *Pre-Course Assignments* is located on page 6.

**Equipment** – With the exception of Discover Scuba Diving you are required to have your own mask, snorkel and fins (and booties, if applicable) for all courses at Pro Dive. Although we have wetsuits for rent, we recommend having your own wetsuit as it is a personalized piece of gear. For career students (Phase I through Phase IV), it is required that you provide all your own scuba equipment and accessories, as you will be conducting skills that require motor skill memory to quickly and effectively get in and out of your equipment. All Pro Dive students receive special discounts on equipment purchases.

**Medical Statement** – The PADI Medical Statement is located on pages 8 and 9. This form is a questionnaire about your medical history. It is imperative that you answer this form accurately and truthfully. If you answer YES to ANY question, you are required to have the form signed by a physician giving approval for you to engage in diving activities. Physician's approval is required for ALL students enrolled in Divemaster and Phase II. The PADI Medical Statement and Guidelines for Recreational Scuba Diver's Physical Examination can be downloaded from our web site at <http://prodiveusa.com/forms.html>.

### ***3. What should I study before my first class begins?***

A list of *Pre-Course Assignments* for each class is located on page 6. Allow yourself ample time to do pre-course readings and Knowledge Reviews. All students are required to come to class fully prepared with completed assignments.

Pro Dive reserves the right to dismiss students from class until such assignments are completed, at which time the student will be responsible for make-up fees at the rate of \$35 per hour. Please see the Pro Dive Student Learning Agreement on page 10.

### ***4. What should I bring to my first day of class?***

You should bring your books and materials (e.g. Crew Paks, Recreational Dive Planners), pencils, pens, highlighters, note pads, etc. Additionally, Career Students (Phase I through Phase IV) should bring calculators, logbooks, and certification cards. Also bring your original PADI Medical Statement with physician's signature when applicable. Many courses include some in-water training on the very first day, so be sure to bring all snorkeling and scuba equipment along with bathing suits and a towel.

### ***5. Where will my open water dives be conducted?***

Pro Dive training dives are conducted in the Atlantic Ocean on the many natural and artificial reefs bordering our shores. When accessing our reefs we utilize the *Pro Diver II*, a 60-foot charter vessel customized for our dive training operations. It is only a 30 to 40 minute trip from our dock to many of our dive sites – with 15 minutes of that time in the protected waters of the Intracoastal Waterway.

We also utilize Fort Lauderdale Beach for beach diving and Tigertail Lake, a diving friendly, man-made freshwater lake only 7 miles from Pro Dive, for freshwater diving. If inclement weather prevents ocean dives, Tigertail Lake will be our alternate open water diving location.

### ***6. What travel issues should I be mindful of when training at Pro Dive?***

A list of nearby hotels that offer special rates to Pro Dive students is located on our website at <http://prodiveusa.com/housing.html>.

***NOTE: When flying after your training at Pro Dive (or driving into mountainous areas) you MUST wait at least 18 hours after your last dive. Book all flights and accommodations so that you depart later than 18 hours after your last dive.***

***Welcome to Pro Dive!***

## ***General Rules***

Pro Dive trains both recreational and professional divers. Please remember that you have enrolled in a professional school and that cooperation is very important and necessary.

### **Here are some general rules for your consideration:**

- Pro Dive is a “smoking-free” campus. No smoking in classrooms, offices, dive center, or on the Pro Diver II.
- Please ensure that your attire is neat and appropriate and at all times maintain personal hygiene standards.
- No wetsuits, booties, swimsuits, bare feet, ripped clothing, or wet gear is allowed in classrooms, offices or dive center.
- Tardiness is disruptive to others. If you are late for a class session you may be required to make-up that session.
- No alcohol is allowed during training hours. Absolutely no drugs or intoxication will be tolerated.
- Final payment is required prior to start of class.

### **Classroom:**

- Please turn off cell phones while in class.
- Please be courteous and respectful of fellow students and instructors by being attentive during presentations.
- Beverages are allowed only if in sealable, screw-down lid containers.
- Pro Dive phones are not to be used for making personal calls.

### **Dive Store:**

- The dive center is open daily during the week from 9:00am to 6:00pm and 8:00am to 6:00pm on the weekend. Due to charter boat trip check-in, the dive center experiences its highest volume of traffic during the periods of 8:00am to 9:30am and 12:00pm to 1:00pm. Please avoid these periods when making weight belt deposits, purchasing books and materials, or to be fitted for dive equipment.
- Students may store their personal dive gear in the gear locker. Please store personal dive gear neatly and be mindful of others’ space needs. Scuba equipment should be contained in a gear bag, and please bring hangers upon which to hang your wetsuits.
- Be sure to put names on ALL equipment. Although the gear locker remains locked when not in use, Pro Dive is not responsible for students’ equipment stored in the gear locker.

### ***Pool:***

- Pro Dive students will use covered lead weights and accompanying belts for pool sessions. These weight systems will be issued to students with a \$50 deposit. All Pro Dive weight belts must be returned to the dive center upon completion of training with the exact belt and weights issued to be eligible for a refund.
- Obey all lifeguard commands and instructions.
- Do not leave tanks standing upright when not attended.
- Do not hold onto lane lines.
- Glass containers are not allowed on deck.
- Lockers are available at the pool, please bring your own lock.
- Leave the pool deck cleaner than it was when you arrived.

### ***Pro Diver II:***

- Please observe all off-limit areas while docking and when underway.
- No glass containers or smoking on board.
- Listen carefully to briefings before and after diving operations.
- Students may enter the bridge if invited by the captain.
- Students' diving equipment should be neat and stowed in the appropriate areas on the boat.
- Please make sure that all gear items are marked with name or initials.
- Leave the boat and reef cleaner than it was when you arrived.
- Unsafe divers are not welcome on the Pro Diver II. Please dive responsibly.

### ***Parking:***

- Students may park in the student parking area of the Pro Dive/Coconuts parking lot. See Campus Map on page 7.
- Follow the directions of the parking lot attendant.
- Please request a Parking Pass from the Administration Office or your Instructor.
- Carpooling with other students eases parking and instills teamwork.

## **Pre-Course Assignments**

### **PADI Open Water Diver**

- Complete PADI eLearning program or read PADI Open Water Diver Manual and complete Knowledge Reviews 1, 2 and 3 prior to the first class.
- Review the RDP instruction booklet. Note: For evening format or private classes, students must also view the Open Water Diver DVD.

### **PADI Advanced Open Water**

- Complete PADI eLearning program or read PADI Adventures in Diving Manual.
- Complete Scuba quick review test and the recreational dive planner review.
- Read and complete knowledge reviews on Underwater Navigation, Night Diving, Deep Diving, Peak Performance Buoyancy and Drift Diving.

### **PADI Master Scuba Diver**

- Complete Drift Diver and Peak Performance Buoyancy Knowledge reviews in the Adventures in Diving Manual plus the Knowledge Reviews in back of each of the PADI Underwater Navigation, Deep and Night specialty manuals. (Note that some of them are in two parts)

### **PADI Emergency First Response /Care for Children**

- Review Materials and complete EFR and CFC knowledge reviews.

### **DAN O2 Provider**

- Review DAN Student Manual complete Knowledge Reviews.

### **PADI Rescue Diver**

- Read and complete all (5) knowledge reviews in PADI Rescue manual.

### **PADI Divemaster**

- Review Divemaster manual, all sections and complete the (9) knowledge reviews.
- Review Encyclopedia sections on physics, physiology and equipment.
- Review the RDP Table and eRDPmI User Guide books and complete all 5 self-quiz sections of the Diving Knowledge Workbook.
- Practice for 400 yard Swim, 800 yard Snorkel Swim, 15 Minute Tread Water and the tired diver tow swim tests.

### **PADI Enriched Air Nitrox Diver**

- Complete PADI eLearning program or read PADI Enriched Air Nitrox manual and complete knowledge reviews.

### **PADI Emergency First Response Instructor Course**

- Review EFR/CFC manuals and EFRI/CFCI outlines.
- Complete (4) Knowledge Reviews on Program Standards, Care for Children, Human Body Systems, and Medical Emergencies.

### **PADI Instructor Development Course - Assistant Instructor & Open Water Scuba Instructor**

- Complete PADI eLearning program or attend live delivery presentations.
- Review sections on physics, physiology, equipment, dive skills & the environment, the RDP Table and eRDPmI. Use PADI materials as references including the Encyclopedia of Recreational Diving and Diving Knowledge Workbook in preparation for the 5-part dive theory exams.

### **PADI Master Scuba Diver Trainer MSDT**

- Review specialty outlines and manuals.

### **DAN Oxygen Provider Instructor**

- Review materials.

### **PADI Enriched Air Nitrox Instructor**

- Review materials.

### **Resort Operations Specialist**

- Review materials.

### **PADI IDC Staff Instructor Course**

- Review CD Materials and prepare for PADI IDC Staff Instructor exams in physics, physiology, equipment, RDP, and skills & environment.

## Pro Dive Campus

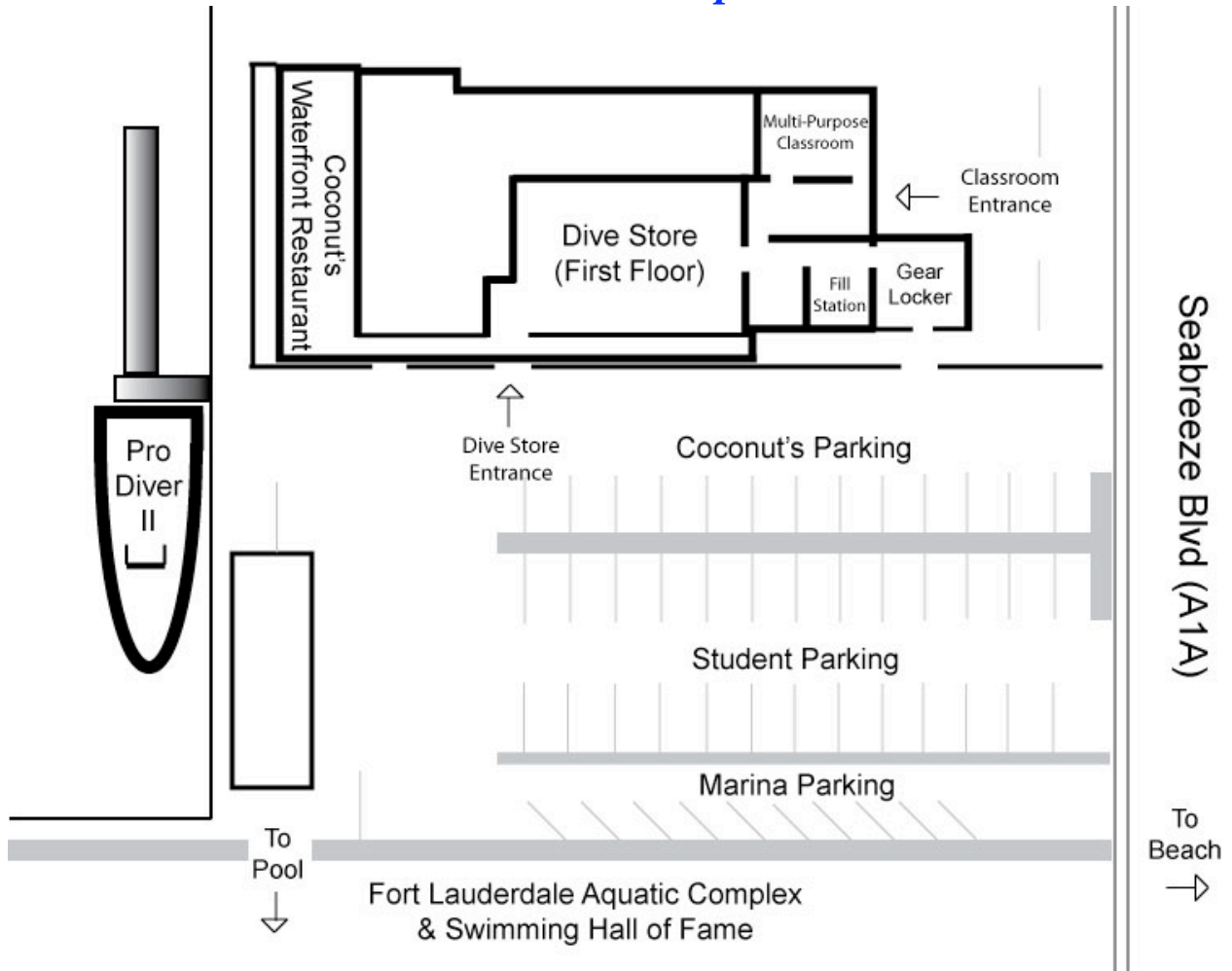

## Second Floor

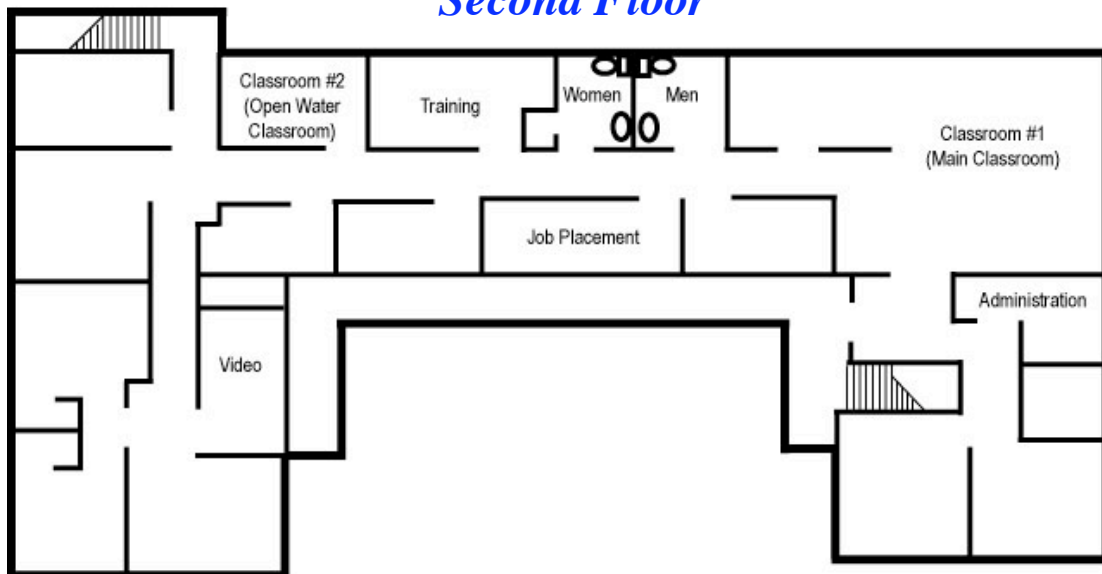



# STUDENT

---

**Please print legibly.**

Name \_\_\_\_\_ Birth Date \_\_\_\_\_ Age \_\_\_\_\_  
First Initial Last Day/Month/Year

Mailing Address \_\_\_\_\_

City \_\_\_\_\_ State/Province/Region \_\_\_\_\_

Country \_\_\_\_\_ Zip/Postal Code \_\_\_\_\_

Home Phone ( ) \_\_\_\_\_ Business Phone ( ) \_\_\_\_\_

Email \_\_\_\_\_ FAX \_\_\_\_\_

## **Name and address of your family physician**

Physician \_\_\_\_\_ Clinic/Hospital \_\_\_\_\_

Address \_\_\_\_\_

Date of last physical examination \_\_\_\_\_

Name of examiner \_\_\_\_\_ Clinic/Hospital \_\_\_\_\_

Address \_\_\_\_\_

Phone ( ) \_\_\_\_\_ Email \_\_\_\_\_

Were you ever required to have a physical for diving?  Yes  No If so, when? \_\_\_\_\_

# PHYSICIAN

---

This person applying for training or is presently certified to engage in scuba (self-contained underwater breathing apparatus) diving. Your opinion of the applicant's medical fitness for scuba diving is requested. There are guidelines attached for your information and reference.

## **Physician's Impression**

I find no medical conditions that I consider incompatible with diving.

I am unable to recommend this individual for diving.

**Remarks** \_\_\_\_\_

\_\_\_\_\_

\_\_\_\_\_

\_\_\_\_\_  
Physician's Signature or Legal Representative of Medical Practitioner Date Day/Month/Year

Physician \_\_\_\_\_ Clinic/Hospital \_\_\_\_\_

Address \_\_\_\_\_

Phone ( ) \_\_\_\_\_ Email \_\_\_\_\_

## ***Learning Agreement With Pro Dive***

Dive training courses are meant to be fun, but like any form of learning, you'll need to invest time and effort by reading and studying. This Learning Agreement is between you (the student) and Pro Dive, regarding our mutual responsibilities of this course.

### ***Student Responsibilities***

The student agrees to study independently as specified by Pro Dive. In general, this means that before each class session the student will:

- Read the appropriate assigned course sections and complete the assigned Knowledge Reviews.

**OR**

- Watch the appropriate assigned portion of the course DVD, CD-ROM or e-Learning and complete the corresponding Knowledge Reviews.

In addition, the student agrees to:

- Complete the PADI Medical Statement prior to the start of class. If a condition is "YES", or if the student is in Phase 1 or later, a physician's signature of approval is required prior to the start of class.
- Secure Dive Accident Insurance (DAN Recommended). *Required for all Diamond and Phase students.*
- Show up for all sessions on time, with all required materials and equipment.
- Ask questions about anything not understood.
- Follow all General Rules as set forth by Pro Dive on pages 4 and 5.

### ***Pro Dive Responsibilities***

Pro Dive instructors and staff agree to:

- Start the class as scheduled.
- Provide a positive learning environment.
- Answer the student's questions to the best of their ability.
- Assist the student through learning challenges.

Student Signature \_\_\_\_\_

Date \_\_\_\_\_

Print Name \_\_\_\_\_